

JURISDICTION

SOUTHEASTERN DISTRICT HEALTH DEPARTMENT

1901 ALVIN RICKEN DRIVE POCATELLO, ID 83201

GW GW 42454

FEE PD Y N
PERMIT # 147424

TRAVEL TIME: 30 min
INSPECTION TIME: 20 min

**APPLICATION AND PERMIT VALID FOR ONE YEAR FROM DATE OF ISSUANCE

NAME: Rudolph M. Isted		PHONE: 233-3424	PROPERTY ADDRESS: 1569 East Fork Mink Creek		
MAILING ADDRESS: 1569 East Fork Mink Crk		LEGAL DESCRIPTION: LOT SIZE (ACRES) 5		1/4 SECTION SW SECTION 8 TOWNSHIP 8 RANGE 35	
STREET/P.O. BOX		CITY: Pocatello		STATE: Idaho	
ZIP: 83204		PARCEL #: R4059000400		FROM TAX ASSESSOR'S OFFICE	
SEPTIC TANK SIZE: 1000 gal.	EST TYPE: 233	EFFECTIVE DISPOSAL AREA: 444 SQ.FT.	SOIL TYPE: B2	MAXIMUM DEPTH BELOW GROUND SURFACE: Replacement	# BEDROOMS: 2

INSTALLATION MUST BE BY LICENSED SEWER INSTALLER OR HOME/LANDOWNER

EHS SIGNATURE: [Signature]	EHS #: 69	APPLICANT SIGNATURE: Rudy Isted	DATE: 06/08/00
----------------------------	-----------	---------------------------------	----------------

REMARKS: Non-conforming Permit, may be less than 200 ft to Creek.

INSPECTION

THE DISTRICT HEALTH DEPARTMENT SHALL BE NOTIFIED OF INSTALLATION 48 HOURS PRIOR TO BACKFILLING

SEPTIC TANK SIZE: 1000 gal. existing	STANDPIPE: <input checked="" type="checkbox"/> YES <input type="checkbox"/> NO	MANHOLE DEPTH: > 18 in.	DEPTH BELOW GROUND SURFACE: 9 ft	ROCK UNDER PIPE: 24 in. ^{containing} infiltrators
EFFECTIVE DISPOSAL AREA: 556 sq. ft.	INSTALLATION APPROVED: <input checked="" type="checkbox"/> DISAPPROVED: <input type="checkbox"/>	INSTALLER: E & G Contractors		INSTALLER: 2/19/00

EHS SIGNATURE: [Signature]	DATE: June 13, 2000	EHS #: 74
----------------------------	---------------------	-----------

REMARKS: Had existing tank pumped, baffles were still in good condition. Non-conforming Creek is less than 200 feet.

WATER SYSTEM

PLANS APPROVED: YES <input checked="" type="checkbox"/> NO <input type="checkbox"/>	SAMPLE COLLECTED BY	DATE	STATE LAB INDICATES INTESTINAL BACTERIA WERE <input type="checkbox"/> WERE NOT <input type="checkbox"/> FOUND
MIN. DISTANCES PER STANDARDS/REGS. YES <input type="checkbox"/> NO <input type="checkbox"/>	CHEMICAL PARAMETERS TESTED WITHIN LIMITS YES <input type="checkbox"/> NO <input type="checkbox"/>		SYSTEM: PUBLIC <input type="checkbox"/> PRIVATE <input checked="" type="checkbox"/>
WELL (SPRING) APPEARS TO MEET CONSTRUCTION STANDARDS AT TIME OF INSPECTION: <input checked="" type="checkbox"/> YES <input type="checkbox"/> NO	EHS SIGNATURE: [Signature]		EHS #: 74
REMARKS			

APPROVED PLANS

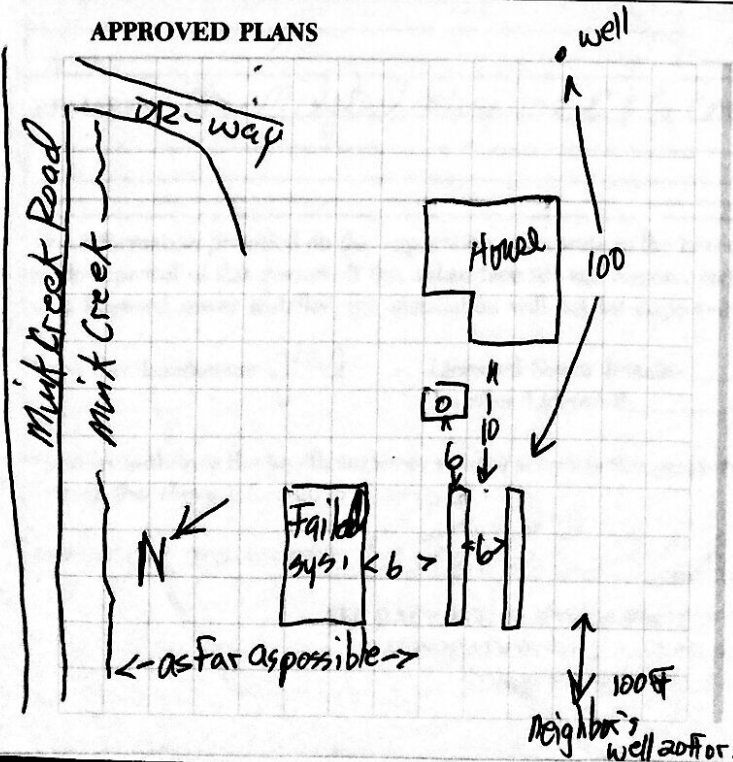

AS BUILT PLANS

