

CW 60W

Jurisdiction
300

Southeastern District Health Department

Fee Paid X Y N
Amount Paid \$500.00
Receipt # 086451
Permit # 175191
Renewal Date _____

EHS # 65 / _____ / _____ / _____
Date 11-18-09 / _____ / _____ / _____
Travel Time 30 / _____ / _____ / _____
Inspection Time 60 / _____ / _____ / _____
EHS # _____ / _____ / _____ / _____
Date _____ / _____ / _____ / _____
Activity Code _____ / _____ / _____ / _____
Office Time _____ / _____ / _____ / _____

APPLICATION & PERMIT VALID FOR ONE YEAR FROM DATE OF ISSUANCE

Exp. Date 10/14/2010

Name Cynthia and Rick Tate Phone 232-7887 Property Address 7727 W. Katsilomaks Rd., Pocatello, ID
Mailing Address 8167 W. Portner Rd. Legal Description: Lot Size (Acres) 5.32
City Pocatello Section 16 Township 7 South Range 35 East
State Idaho Zip 83204 Lot # - Block # - Subdivision _____
Septic Tank Size 1000 gal. Est. Type 233 Effective Disposal Area _____ Sq. Ft. Soil Type _____ Maximum Depth Below Ground Surface _____ # Bedrooms 4

INSTALLATION MUST BE BY LICENSED SEWER INSTALLER OR HOME/LANDOWNER

Date 10/14/2009 EHS Signature Ken Keller EHS # 58 Applicant Signature Cynthia Tate

Remarks Existing septic tank is filling with mud. Location of existing system is unknown. Failed septic tank must be properly abandoned. New septic tank and effluent line must be minimum 50' from any well, minimum 5' from property line.

Permit application is attached hereto and is incorporated by reference herein.

Septic Tank Size 1000 gal. K&G Round Standpipe Y X N Manhole Depth Surface Depth Below Existing Ground Surface 80" Rock Under Pipe - No. & Type of Dome existing
Effective Disposal Area Existing sq. ft. Code V-333 INSTALLATION APPROVED X DISAPPROVED _____ Installer The hae Works 881
EHS Signature Craig Madson Date 11/18/09 EHS # 65
Remarks extension on tank to surface

WATER SYSTEM

Min. Distances Per Regs. From Septic System Y X N Water System Public _____ Private X

APPROVED PLANS

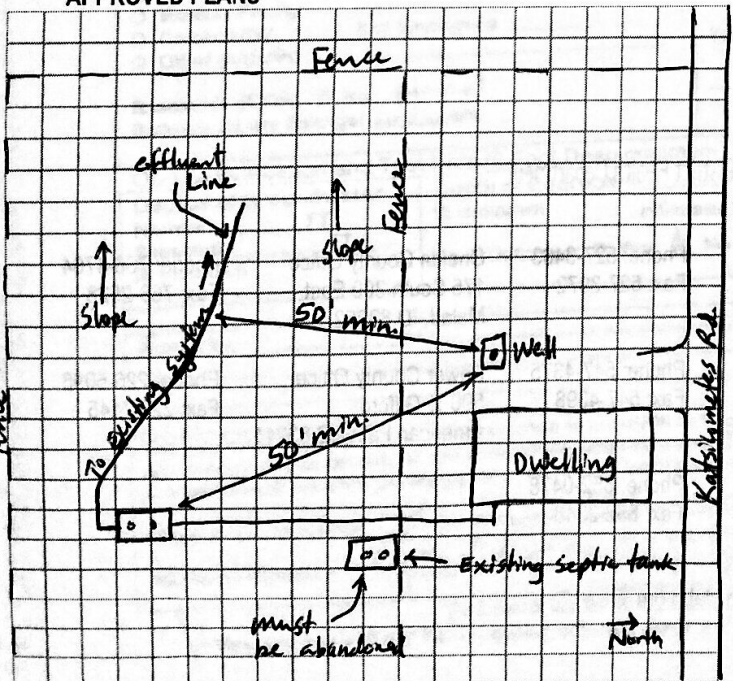

AS BUILT PLANS FENSO

