

PERMISSION 399

09/01/98  
69

SOUTHEASTERN DISTRICT HEALTH DEPARTMENT  
465 MEMORIAL DRIVE  
POCATELLO, ID

6WJGOW

FEE PD 92.00 N  
PERMIT # 128010

TRAVEL TIME: 15  
INSPECTION TIME: 30

Code G

\*\*APPLICATION AND PERMIT VALID FOR ONE YEAR FROM DATE OF ISSUANCE

NAME <i>Roger Schei</i>	PHONE 238-8224	PROPERTY ADDRESS 5555 Highline Road
MAILING ADDRESS: PO BOX 5691	LEGAL DESCRIPTION: LOT SIZE (ACRES) 2	1/4 SECTION 5 SECTION 2 TOWNSHIP 6 RANGE 34
STREET/P.O. BOX	LOT #	BLOCK #
CITY <i>Chubbuck</i>	SUBDIVISION	
STATE <i>IDAHO</i>	ZIP <i>83202</i>	PARCEL # <i>12CCPC005606</i>
SEPTIC TANK SIZE <i>1000</i> gal.	EST TYPE <i>232</i>	EFFECTIVE DISPOSAL AREA <i>556</i> SQ.FT.
	SOIL TYPE <i>B-2</i>	MAXIMUM DEPTH BELOW GROUND SURFACE <i>4ft</i>
		# BEDROOMS <i>3</i>

INSTALLATION MUST BE BY LICENSED SEWER INSTALLER OR HOME/LANDOWNER

EHS SIGNATURE <i>[Signature]</i>	EHS # <i>69</i>	APPLICANT SIGNATURE <i>David J. Jodie</i>	DATE <i>5-27-98</i>
-------------------------------------	-----------------	--	------------------------

REMARKS

INSPECTION

THE DISTRICT HEALTH DEPARTMENT SHALL BE NOTIFIED OF INSTALLATION 48 HOURS PRIOR TO BACKFILLING

SEPTIC TANK SIZE <i>1000</i> gal	STANDPIPE: (X) YES ( ) NO	MANHOLE DEPTH <i>12 in</i>	DEPTH BELOW GROUND SURFACE <i>4ft</i>	ROCK UNDER PIPE <i>19 Infiltrators</i>
EFFECTIVE DISPOSAL AREA <i>556</i> sq. ft.	INSTALLATION APPROVED (X) DISAPPROVED	INSTALLER <i>Western Design</i>	INSTALLER # <i>22815</i>	

EHS SIGNATURE <i>[Signature]</i>	DATE <i>09/01/98</i>	EHS # <i>69</i>
-------------------------------------	-------------------------	--------------------

REMARKS *10 inches off outlet Baffle had to be removed.*

WATER SYSTEM

PLANS APPROVED YES (X) NO	SAMPLE COLLECTED BY	DATE	STATE LAB INDICATES INTESTINAL BACTERIA WERE WERE NOT FOUND
MIN. DISTANCES PER STANDARDS/REGS. YES (X) NO	CHEMICAL PARAMETERS TESTED WITHIN LIMITS YES NO	SYSTEM PUBLIC (X) PRIVATE	
WELL (SPRING) APPEARS TO MEET CONSTRUCTION STANDARDS AT TIME OF INSPECTION ( ) YES ( ) NO	EHS SIGNATURE	EHS #	

REMARKS

APPROVED PLANS

AS BUILT PLANS

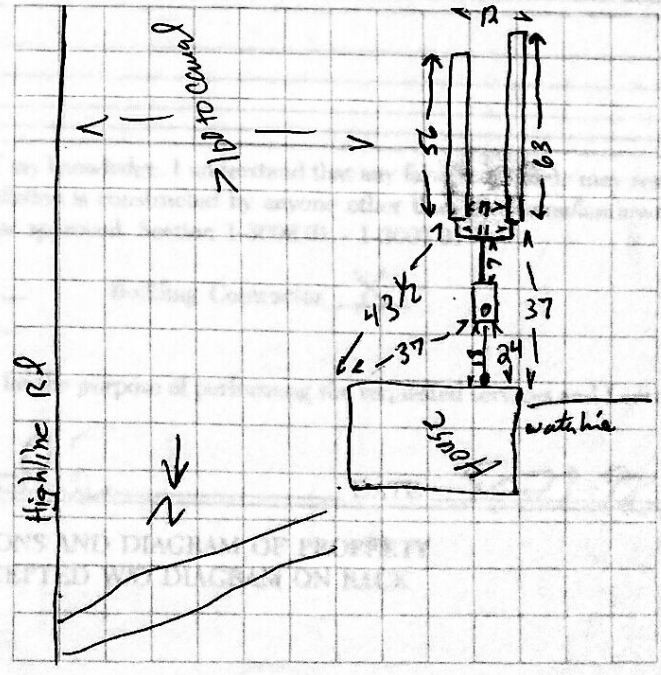
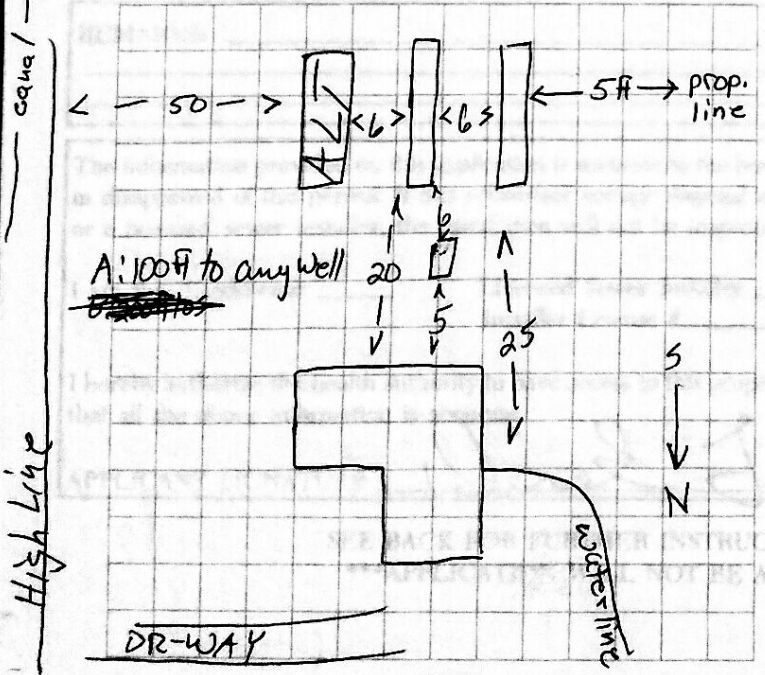

Highline

Highline Rd