

JURISDICTION 0300 9/1/94 SOUTHEASTERN DISTRICT HEALTH DEPARTMENT
9/1/94 65 MEMORIAL DRIVE POCATELLO, ID
 TRAVEL TIME: 30 / 30
 INSPECTION TIME: 30 / 30

GW, GW
 FEE PD Y N
 PERMIT # 84382

****APPLICATION AND PERMIT VALID FOR ONE YEAR FROM DATE OF ISSUANCE**

NAME <u>Dan Obray</u>		PHONE <u>237-3617</u>	PROPERTY ADDRESS <u>Rio Vista Between Siphon & Chulbuck Rd</u>		
MAILING ADDRESS:		LEGAL DESCRIPTION: LOT SIZE (ACRES) <u>10</u> / <u>10</u>			
STREET/P.O. BOX <u>1432 Zander</u>		¼ SECTION <u>SW</u> SECTION <u>5</u> TOWNSHIP <u>6S</u> RANGE <u>34E</u>			
CITY <u>Pocatello</u>		LOT # _____ BLOCK # _____ SUBDIVISION _____			
STATE <u>Id</u>		ZIP <u>83202</u>		PARCEL # <u>R3853008100</u> FROM TAX ASSESSOR'S OFFICE	
SEPTIC TANK SIZE <u>1000 gal.</u>	EST TYPE <u>232</u>	EFFECTIVE DISPOSAL AREA <u>667</u> SQ.FT.	SOIL TYPE <u>B1</u>	MAXIMUM DEPTH BELOW GROUND SURFACE <u>4</u>	# BEDROOMS <u>4</u>

INSTALLATION MUST BE BY LICENSED SEWER INSTALLER OR HOME/LANDOWNER

EHS SIGNATURE <u>Chris Madson</u>	EHS # <u>65</u>	APPLICANT SIGNATURE <u>[Signature]</u>	DATE <u>6-10-94</u>
REMARKS			

INSPECTION

THE DISTRICT HEALTH DEPARTMENT SHALL BE NOTIFIED OF INSTALLATION 48 HOURS PRIOR TO INSTALLATION

SEPTIC TANK SIZE <u>1000</u> gal	STANDPIPE: <input checked="" type="checkbox"/> YES <input type="checkbox"/> NO	MANHOLE DEPTH <u>18"</u>	DEPTH BELOW GROUND SURFACE <u>3-4'</u>	ROCK UNDER PIPE <u>NA</u>
EFFECTIVE DISPOSAL AREA <u>414</u> sq. ft.	INSTALLATION APPROVED <input checked="" type="checkbox"/> <u>9/1/94</u> DISAPPROVED <input type="checkbox"/> <u>X</u>	INSTALLER <u>SKIP YANCY</u>		INSTALLER # <u>981</u>
EHS SIGNATURE <u>[Signature]</u>	DATE <u>9/1/94</u>	EHS # <u>61</u>		
REMARKS <u>400 FT² REQUIRED FOR INFILTRATOR</u>				

WATER SYSTEM

PLANS APPROVED YES <input checked="" type="checkbox"/> NO _____	SAMPLE COLLECTED BY	DATE <u>9/1/94</u>	STATE LAB INDICATES INTESTINAL BACTERIA WERE _____ WERE NOT _____ FOUND
MIN. DISTANCES PER STANDARDS/REGS. YES <input checked="" type="checkbox"/> NO _____	CHEMICAL PARAMETERS TESTED WITHIN LIMITS YES _____ NO _____		SYSTEM PUBLIC _____ PRIVATE <input checked="" type="checkbox"/>
WELL (SPRING) APPEARS TO MEET CONSTRUCTION STANDARDS AT TIME OF INSPECTION <input checked="" type="checkbox"/> YES <input type="checkbox"/> NO	EHS SIGNATURE <u>[Signature]</u>		EHS # <u>61</u>
REMARKS			

APPROVED PLANS

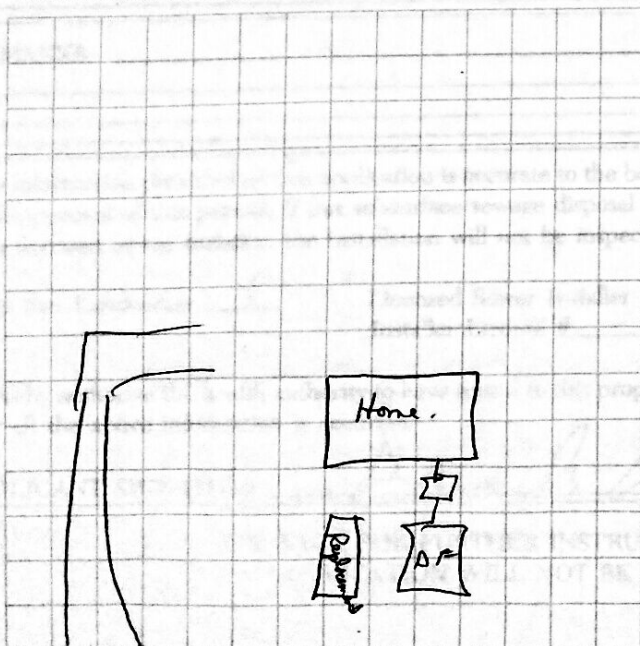

Rivista Rd.

AS BUILT PLANS

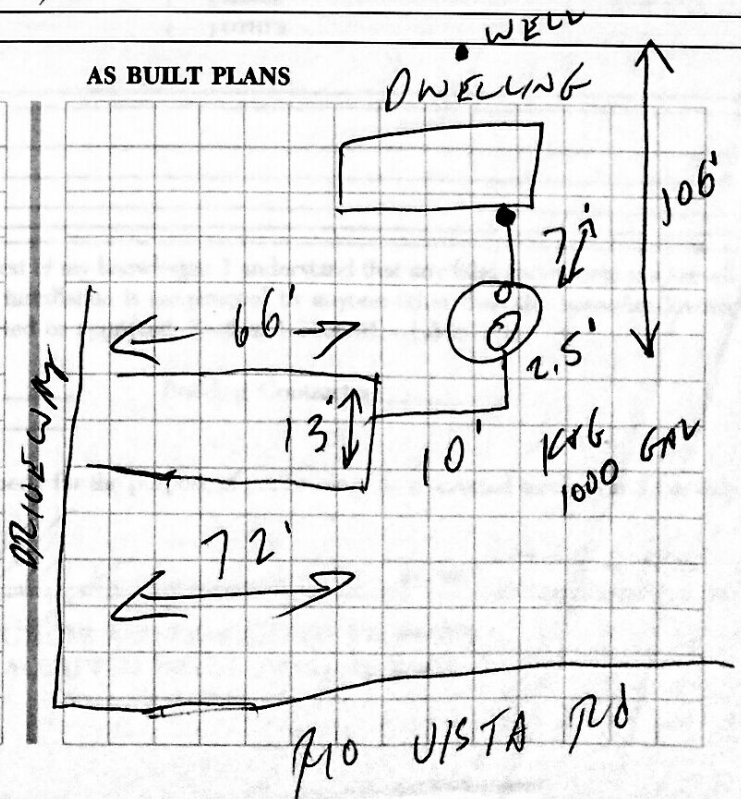

Rivista Rd