

WATER AND SEWER PERMIT

Southeastern *ll sw*
District Health Department

PLANNING & ZONING APPROVAL

Name Glen Houghton	Phone 232-8032	Property Address
Address 8611 Kraft Rd, Pocatello		Legal Description R34E T6S Sect 21 NW 1/4 SE 1/4
Report To	Funding <input type="checkbox"/> Governmental <input type="checkbox"/> Individual	<input type="checkbox"/> Conventional <input type="checkbox"/> Existing Loan No.

SEWAGE SYSTEM

Installation shall comply with all requirements of Health District and/or State of Idaho sewage disposal rules, regulations and standards

Permit No. 3118	
No. Bedrooms: 4 Septic Tank: 1000 gal. Disposal Area: 604 sq. ft.	TYPE: <input checked="" type="checkbox"/> Trench <input type="checkbox"/> Pit <input type="checkbox"/> Sand Filter <input type="checkbox"/> Bed <input type="checkbox"/> E.T. <input type="checkbox"/> Modified Permit Fee: \$50.00
Dimensions: 4 feet Maximum Depth below Ground Surface: 4 feet	PLOT PLAN: <input checked="" type="checkbox"/> Approved <input type="checkbox"/> Disapproved By: Eric Mundell Date: 9.3.85 Remarks: system sized for 4 bedroom house - a temporary 3 bedroom trailer will be used in interim.
Applicant's Signature: Glen Houghton Permit Fee: \$50.00	

INSPECTION

The District Health Department shall be notified of installation **48 hrs** prior to installation **backfill**

SEPTIC TANK Size: 1000 gal.	STANDPIPE: <input checked="" type="checkbox"/> Yes <input checked="" type="checkbox"/> No	Manhole Depth: 12"	DEPTH OF: 6"	Ground Water	Bedrock	Gravel	Rock Under Pipe
Minimum Distances as per Regulations: <input checked="" type="checkbox"/> Yes <input type="checkbox"/> No	Approved Aggregate: <input checked="" type="checkbox"/> Yes <input type="checkbox"/> No	Effective Disposal Area: 642 sq. ft.	Installer: SELF				
EXISTING SYSTEM: <input type="checkbox"/> Yes <input type="checkbox"/> No	Appears to meet Standards/Regs: <input type="checkbox"/> Yes <input type="checkbox"/> No	INSTALLATION: <input checked="" type="checkbox"/> Approved <input type="checkbox"/> Disapproved	By: D. Hancock		Date: 8/15/88		

WATER SYSTEM

Plans Approved: <input type="checkbox"/> Yes <input type="checkbox"/> No	State Laboratory indicates intestinal bacteria: <input type="checkbox"/> were <input type="checkbox"/> were not found in water.	Sample Collected By	Date	Permit Fee
Min. Distances as per Standards/Regs: <input type="checkbox"/> Yes <input type="checkbox"/> No	CHEMICAL TOLERANCES: <input type="checkbox"/> Yes <input type="checkbox"/> No <input type="checkbox"/> Not Chk'd	System: <input type="checkbox"/> Public <input type="checkbox"/> Private	Complies with Health Dist. and/or State of Idaho Standards/Regs: <input type="checkbox"/> Yes <input type="checkbox"/> No	
Existing System appears to comply with all requirements of Health Dist. and State of Idaho Drinking Water Standards/Regs: <input type="checkbox"/> Yes <input type="checkbox"/> No		INSTALLATION: <input type="checkbox"/> Approved <input checked="" type="checkbox"/> Disapproved	By: X	

Remarks: **Existing well**

DIAGRAM

Where applicable, diagram shall include orientation of components of water and sewage systems

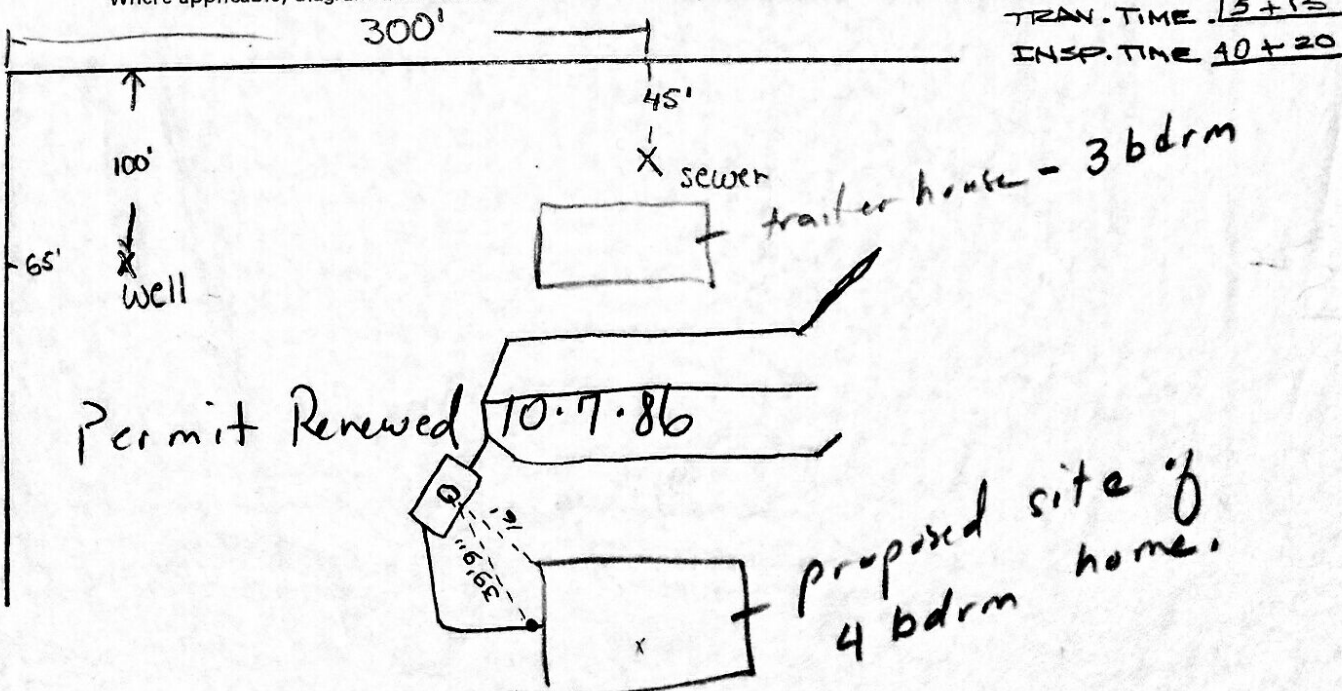

DISAPPROVED: 7-8-88
 Piping in to & out of septic tank not approved.
 APPROVED: 8/15/88 AL

Permit Renewed 10.7.86

Proposed site of 4 bdrm home.